

Compliance of Warlingham Archery Club with the Rules of Shooting specific to OUTDOOR ranges (safety).

BACKGROUND

Warlingham Archery Club (WAC) has been shooting at the field at Warlingham Park School (WPS) since 1995. The field is used predominantly for target archery on Sundays and summer Wednesday evenings.

WAC also holds clout events 4 times each year (including the county clout championships/ open tournament).

An adjacent area may also be used concurrently for beginners' classes, "have a go" and members wishing to tune their bows or practice their shooting technique.

Refer to the schematic diagram of the shooting field, below. Buildings bound the field on 2 sides with open fields (accessible to public) on the other 2 sides.

The Club has an 'Emergency Action Plan' displayed on inside of shed door.

Location

The outdoor range is based within the grounds of Warlingham Park School, Chelsfield Road, Warlingham, Surrey, CR6 9PB.

Shooting capacity

The field has capacity for about 100 archers shooting target archery and 60 shooting clout.

In practice, the maximum target numbers are about 30 for Club events and 50 for the interclub friendly. For the county clout championships the number of archers is about 50.

Access arrangements.

Access to the field is from Chelsfield Road, via the car park (see schematic diagram, below).

References:

Rules of shooting, Archery GB, as amended.

WAC Risk assessment: general risks, Warlingham Archery Club, as amended.

Compliance with the Rules of Shooting specific to outdoor ranges (safety).

The Club complies with Archery GB's 'Rules of shooting'. A general risk assessment is available separately. Range specific safety compliance is detailed below.:

Requirement (AGB rule no.)	Comply	Compliance description
301(h) A waiting line shall be placed at least five yards behind the shooting line.	Y	<p>Club Members' shoots: a line is not used but members place equipment and wait at least 5 yards behind the shooting line.</p> <p>Beginners' classes: a waiting line is placed at least 5 yards behind the shooting line.</p> <p>Target Tournaments: a waiting line is placed at least 5 yards behind the shooting line.</p> <p>Clout tournaments: a line is not used but archers place equipment and wait at least 10' from the shooting line.</p>

Compliance of Warlingham Archery Club with the Rules of Shooting specific to OUTDOOR ranges (safety).

Requirement (AGB rule no.)	Comply	Compliance description
301 (j) All tents and other shelters (except those for the judge's use) and all spectators shall be at least 10 yards behind the shooting line, maintaining adequate room for the free passage of competitors and officials. Spectators shall not advance in front of this tent line without agreement of the Judge.	Y	Target tournaments: a virtual tent line is in place, identified by side markers, at least 10 yards behind the shooting line.
302 (a) Overshoot distances; (ii) Bows shot off the fingers: a. At target distances up to 60 yards/metres the overshoot line shall be at least 110 yards from the shooting line. b. At target distances over 60 yards/metres the overshoot line shall be at least 50 yards from the target line.	Y	Shooting lines A, B, C & D comply Shooting lines A, C & D comply. Shooting line B <u>shall not</u> be used for targets over 60 yards/metres.
302 (a) Overshoot distances; (iii) Bows shot with Mechanical Release Aids (compound bows). At all target distances the overshoot line shall be at least 150 yards from the shooting line.	Y	Lines A, C & D comply. Line B <u>shall not</u> be used for these bows.
302 (b) Side Safety Areas. Each side safety area is the area in front of the shooting line and to the side of the range (including the overshoot area) enclosed by a line from a point 10yds to the side of the shooting line, to a point 20yds to the side of the range at 100yds from the shooting line, and continuing on that straight line to the overshoot line. Note: If the overshoot line is 150yds from the shooting line, the side safety area at that distance will extend 25yds to the side of the range.	Y Y	Lines A, B, C & D comply Lines A, C & D comply Requirement is not applicable to line B as mechanical release bows are not shot from this line (see 302a).
302 (c) Roping of Areas. (i) ALL GROUNDS are deemed accessible by the public even if that involves trespass. (ii) On grounds where the public have a right of access ...	Y	WPS grounds are private and have a perimeter fence. The public do not have right of access. The only authorised entrance to the field is via the car park. However, trespass could be possible by determined individuals.

Compliance of Warlingham Archery Club with the Rules of Shooting specific to OUTDOOR ranges (safety).

Requirement (AGB rule no.)	Comply	Compliance description
302c, continued...		<p>During tournaments notices are placed in the car park warning members of public that archery is in progress.</p> <p>Any incursion onto the field will trigger a halt in shooting. Shooting will not recommence until the field captain is confident that the field is clear.</p>
<p>302 (d) Independent Ranges.</p> <p>Where 2 adjacent ranges are in use independently, each must have its own safety area.</p>	Y	<p>Lines A & B may be used concurrently. Line A is for target archery and for archers tuning bows with a mechanical release aid (under the control of the same field captain).</p> <p>Line B is for Beginners' classes or members practising technique or tuning bows (finger release)</p>
<p>700 (Clout shooting)</p> <p>(b) The Organisers shall take all reasonable steps to ensure that there be no risk occasioned to people, animals or property from arrows that miss the target area by overshoot or to either side (a distance of 50 yards from the Clout centre to the boundary of any land to which the public has access is deemed reasonable).</p>	Y	<p>Line C shows the Clout shooting line. There is >50yds overshoot from the centre of the Clout to the edges of the field.</p> <p>However, if members of the public are seen near or at the perimeter (very rare) shooting will be halted until they disperse.</p> <p>All other sections of rule 700 are complied with.</p>

SCHEMATIC DIAGRAM. Not to scale. Measurements are in yards.

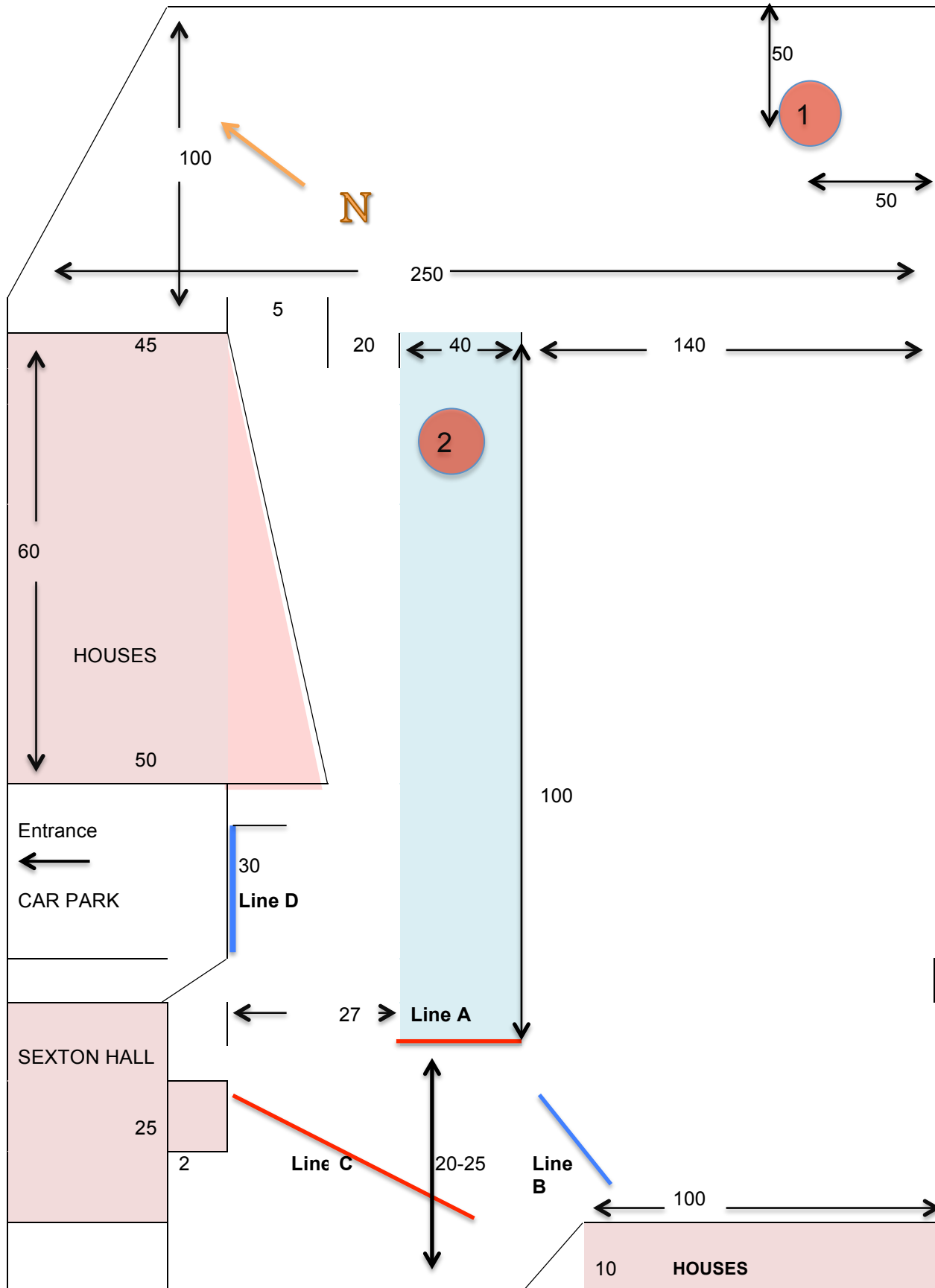

Compliance of Warlingham Archery Club with the Rules of Shooting specific to OUTDOOR ranges (safety).

LINE	RANGE USE	LENGTH, yards	OVERSHOOT*
A	Main target archery shooting line (Shaded area) Tuning/practice compound bows (mechanical release) shall extend to the right of target shooting line	100	100
B	Beginners'/alternative shooting line	60, max	60 - 70
C	Clout shooting line: :	(1) Gents, 180 (2) Ladies, 140	50+ 100-120
D	Winter shooting line (when field is very wet and no/little sun)	60, max	100+

* Distance behind maximum target line.